

# ISUZU FX-Series



08600 ISUZU (47898)  
[www.isuzutrucks.co.za](http://www.isuzutrucks.co.za)

The information in this brochure was correct at time of printing, but all measurements, specifications and equipment are subject to change without notice. Some equipment may have been changed and is available at extra cost. Isuzu Truck South Africa (ITSA) may make changes at any time, without notice, in prices, colours, materials, equipment and models. ITSA makes all reasonable attempts to ensure the availability of all vehicles and equipment. The information in this brochure is general in nature. Your nearest Isuzu Truck Dealer can confirm all measurements, specifications and vehicle/equipment availability on request. Bodies and applications illustrated are not standard equipment. E&OE

**ISUZU**  
 TRUCKS  
*For the long run*

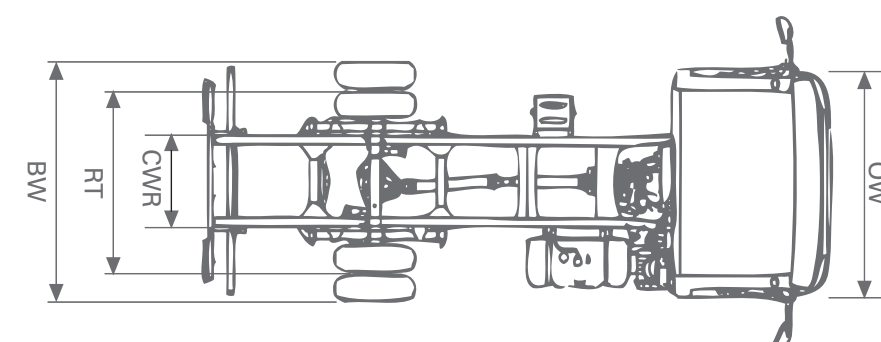
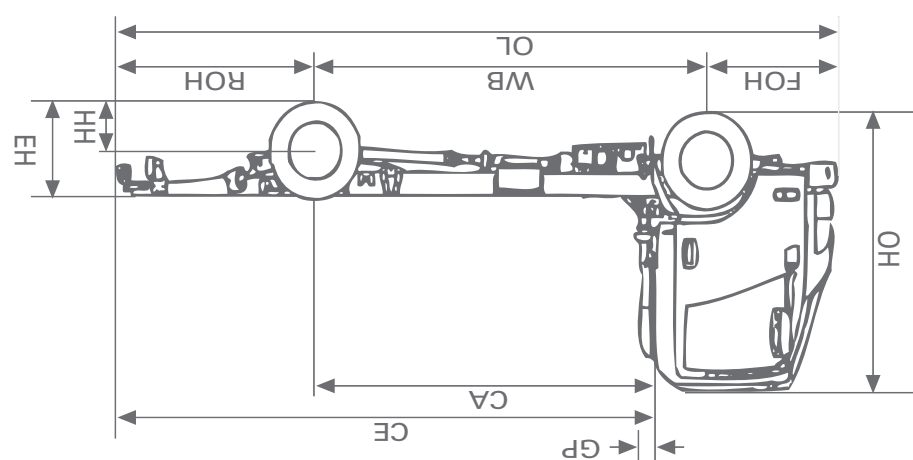



<b>ISUZU - FX SERIES</b>	<b>FXR 17-360 4 x 2 FREIGHTER</b>	<b>FXZ 26-360 6 x 4 FREIGHTER</b>	<b>FXZ 28-360 6 x 4 COMPACTOR</b>	<b>GXR 35-360 4 x 2 T - TRACTOR</b>	<b>GXR 40-360 4 x 2 T - TRACTOR</b>	<b>FXZ 26-360 6 x 4 MIXER*</b>	<b>FXZ 26-360 6 x 4 TIPPER*</b>	<b>GXZ 45-360 6 x 4 T - TRACTOR*</b>	
<b>ENGINE</b>									
Model	6UZ1-TCC	6UZ1-TCC	6UZ1-TCC	6UZ1-TCC	6UZ1-TCC	6UZ1-TCC	6UZ1-TCC	6UZ1-TCC	
Type	TURBOCHARGED & INTERCOOLED	TURBOCHARGED & INTERCOOLED	TURBOCHARGED & INTERCOOLED	TURBOCHARGED & INTERCOOLED	TURBOCHARGED & INTERCOOLED	TURBOCHARGED & INTERCOOLED	TURBOCHARGED & INTERCOOLED	TURBOCHARGED & INTERCOOLED	
Fuel Injection	Common Rail	Common Rail	Common Rail	Common Rail	Common Rail	Common Rail	Common Rail	Common Rail	
Emission Standard	Euro 3	Euro 3	Euro 3	Euro 3	Euro 3	Euro 3	Euro 3	Euro 3	
No. of Cylinders	6	6	6	6	6	6	6	6	
Bore x Stroke (mm)	120 x 145	120 x 145	120 x 145	120 x 145	120 x 145	120 x 145	120 x 145	120 x 145	
Displacement (cm3)	9,839	9,839	9,839	9,839	9,839	9,839	9,839	9,839	
Compression Ratio (:1)	17.5	17.5	17.5	17.5	17.5	17.5	17.5	17.5	
Output ( kW @ r/min )	265 @ 2,000	265 @ 2,000	265 @ 2,000	265 @ 2,000	265 @ 2,000	265 @ 2,000	265 @ 2,000	265 @ 2,000	
Output ( hp @ r/min )	355 @ 2,000	355 @ 2,000	355 @ 2,000	355 @ 2,000	355 @ 2,000	355 @ 2,000	355 @ 2,000	355 @ 2,000	
Torque ( Nm @ r/min )	1,422 @ 1,400	1,422 @ 1,400	1,422 @ 1,400	1,422 @ 1,400	1,422 @ 1,400	1,422 @ 1,400	1,422 @ 1,400	1,422 @ 1,400	
<b>CLUTCH</b>									
Type	SINGLE PLATE	SINGLE PLATE	SINGLE PLATE	SINGLE PLATE	SINGLE PLATE	SINGLE PLATE	SINGLE PLATE	SINGLE PLATE	
Diameter (mm)	430	430	430	430	430	430	430	430	
Operation	AIR ASSISTED HYDRAULIC CONTROL	AIR ASSISTED HYDRAULIC CONTROL	AIR ASSISTED HYDRAULIC CONTROL	AIR ASSISTED HYDRAULIC CONTROL	AIR ASSISTED HYDRAULIC CONTROL	AIR ASSISTED HYDRAULIC CONTROL	AIR ASSISTED HYDRAULIC CONTROL	AIR ASSISTED HYDRAULIC CONTROL	
<b>TRANSMISSION</b>									
Make / Model	ZF9S1310	ZF9S1310	ZF9S1310	ZF9S1310	ZF9S1310	ZF9S1310	ZF9S1310	ZF9S1310	
Crawler Gear Ratio (:1)	9.480	9.480	9.480	9.480	9.480	9.480	9.480	9.480	
1st Gear Ratio (:1)	6.580	6.580	6.580	6.580	6.580	6.580	6.580	6.580	
2nd Gear Ratio (:1)	4.680	4.680	4.680	4.680	4.680	4.680	4.680	4.680	
3rd Gear Ratio (:1)	3.480	3.480	3.480	3.480	3.480	3.480	3.480	3.480	
4th Gear Ratio (:1)	2.620	2.620	2.620	2.620	2.620	2.620	2.620	2.620	
5th Gear Ratio (:1)	1.890	1.890	1.890	1.890	1.890	1.890	1.890	1.890	
6th Gear Ratio (:1)	1.350	1.350	1.350	1.350	1.350	1.350	1.350	1.350	
7th Gear Ratio (:1)	1.000	1.000	1.000	1.000	1.000	1.000	1.000	1.000	
8th Gear Ratio (:1)	0.750	0.750	0.750	0.750	0.750	0.750	0.750	0.750	
Reverse Gear Ratio (:1)	8.960	8.960	8.960	8.960	8.960	8.960	8.960	8.960	
<b>PERFORMANCE</b>									
Maximum Speed (km/h)	110	102	102	101	101	102	102	101	
Gradeability @ V in 1st gear (%)	45.91	28.88	-	17.14	17.14	28.88	28.88	-	
<b>SUSPENSION</b>									
Front				MULTI LEAF SPRING WITH DOUBLE ACTING SHOCK ABSORBERS, STABILISER BAR					
Rear				MULTI LEAF SPRING WITH DOUBLE ACTING SHOCK ABSORBERS, STABILISER BAR					
<b>BRAKES</b>									
System	FULL AIR	FULL AIR	FULL AIR	FULL AIR	FULL AIR	FULL AIR	FULL AIR	FULL AIR	
Park Brake	REAR WHEELS	REAR WHEELS	REAR WHEELS	REAR WHEELS	REAR WHEELS	REAR WHEELS	REAR WHEELS	REAR WHEELS	
Front	DRUM	DRUM	DRUM	DRUM	DRUM	DRUM	DRUM	DRUM	
Rear	DRUM	DRUM	DRUM	DRUM	DRUM	DRUM	DRUM	DRUM	
ABS	STANDARD	STANDARD	STANDARD	STANDARD	STANDARD	STANDARD	STANDARD	STANDARD	
Auxiliary	EXHAUST BRAKE	EXHAUST BRAKE	EXHAUST BRAKE	EXHAUST BRAKE	EXHAUST BRAKE	EXHAUST BRAKE	EXHAUST BRAKE	EXHAUST BRAKE	
Retarder	-	-	-	-	ELECTROMAGNETIC RETARDER ( 1 )	-	-	ELECTROMAGNETIC RETARDER ( 2 )	
<b>STEERING</b>									
Lock to Lock (No of turns)	4.5	4.5	4.5	4.5	4.5	4.5	4.5	4.5	
Operation	POWER	POWER	POWER	POWER	POWER	POWER	POWER	POWER	
<b>CAB</b>									
Control	FORWARD	FORWARD	FORWARD	FORWARD	FORWARD	FORWARD	FORWARD	FORWARD	
Tilt	YES	YES	YES	YES	YES	YES	YES	YES	
<b>WHEELS &amp; TYRES</b>									
Type	RADIAL	RADIAL	RADIAL	RADIAL	RADIAL	RADIAL	RADIAL	RADIAL	
Tubeless									
Tyre Size (Front)	315/80R22.5	315/80R22.5	315/80R22.5	315/80R22.5	315/80R22.5	315/80R22.5	315/80R22.5	315/80R22.5	
Tyre Size (Rear)	315/80R22.5	315/80R22.6	315/80R22.7	315/80R22.5	315/80R22.5	315/80R22.6	315/80R22.7	315/80R22.8	
Wheel Size (Front)	9.0xR22.5	9.0xR22.5	9.0xR22.5	9.0xR22.5	9.0xR22.5	9.0xR22.5	9.0xR22.5	9.0xR22.5	
Wheel Size (Rear)	9.0xR22.5	9.0xR22.6	9.0xR22.7	9.0xR22.9	9.0xR22.8	9.0xR22.10	9.0xR22.11	9.0xR22.12	
<b>FUEL TANK (Lockable)</b>									
Capacity (Litres)	400	400	400	400	400	400	400	400	
<b>FRONT AXLE</b>									
Model	ISUZU F075	ISUZU F075	ISUZU F075	ISUZU F075	ISUZU F075	ISUZU F075	ISUZU F075	ISUZU F075	
<b>REAR AXLE</b>									
Model	ISUZU R130	ISUZU RT210	ISUZU RT210	ISUZU R130	ISUZU R130	ISUZU RT210	ISUZU RT210	ISUZU RT210	
Final Drive Ratio (:1)	4.556	4.556	4.556	4.875	4.875	5.125	5.125	5.571	
<b>ELECTRICAL SYSTEM</b>									
System Voltage (V)	24	24	24	24	24	24	24	24	
Alternator (Amps)	90	90	90	90	90	90	90	90	
<b>DIMENSIONS (mm)</b>									
OL – Overall Length	9,990	10,985	10,985	5,995	5,995	9,305	9,305	6,615	
OW – Overall Width	2,490	2,490	2,490	2,490	2,490	2,490	2,490	2,490	
OH – Overall Height	2,980	2,980	2,980	2,980	2,980	2,980	2,980	2,980	
WB – Wheelbase	5,740	6,010	6,010	3,480	3,480	4,330	4,330	4,100	
FDH – Front Overhang	1,480	1,480	1,480	1,480	1,480	1,480	1,480	1,480	
ROH – Rear Overhang	2,770	3,495	3,495	1,035	1,035	3,495	3,495	1,035	
BW – Rear Axle Width	2,520	2,520	2,520	2,520	2,520	2,520	2,520	2,520	
FT – Front Track	2,065	2,065	2,065	2,045	2,045	2,065	2,065	2,045	
RT – Rear Track	1,850	1,850	1,850	1,850	1,850	1,850	1,850	1,850	
EH – Chassis Rear End Height	1,135	1,150	1,150	1,095	1,095	1,150	1,150	1,095	
CWF - Front Chassis Width	850	850	850	850	850	850	850	850	
CWR – Rear Chassis Width	850	850	850	850	850	850	850	850	
HH – Rear Ground Clearance	260	260	260	260	260	260	260	260	
CE – Cab to Chassis End	7,950	8,900	8,900	3,900	3,900	8,900	8,900	3,900	
CA – Cab to Axle	5,260	5,510	5,510	3,000	3,000	5,510	5,510	3,000	
GP – Minimum Body Gap	55	55	55	-	-	55	55	-	
Turning Circle (kerb to kerb)	19.17	20.00	20.00	12.70	12.70	13.50	13.50	13.01	
<b>MASS DATA (kg)</b>									
Manufacturer's GVM	16,500	25,500	28,000	16,500	16,500	25,500	25,500	25,500	
Permissible Gross Mass (V)	16,500	25,500	27,900	16,500	16,500	25,500	25,500	25,500	
Manufacturer's GCM	36,000	45,000	45,000	34,500	40,500	43,500	43,500	43,500	
Permissible Combination Mass (D/T)	36,000	45,000	45,000	34,500	40,500	43,500	43,500	43,500	
Front Axle Tare Mass	3,950	4,040	4,040	3,930	3,980	4,040	4,040	4,040	
Rear Axle Tare Mass	2,200	3,960	3,960	2,130	2,070	3,960	3,960	3,960	
Total Tare Mass	6,150	8,000	8,000	6,060	6,050	8,000	8,000	8,000	
Gross Axle Mass Load - Front (GA1)	7,500	7,500	7,500	7,500	7,500	7,500	7,500	7,500	
Gross Axle Mass Load - Rear (GA2)	13,000	21,000	21,000	13,000	13,000	21,000	21,000	21,000	
Permissible Axle Load - Front (A1)	7,500	7,500	7,500	7,500	7,500	7,500	7,500	7,500	
Permissible Axle Load - Rear (A2)	9,000	18,000	20,400	9,000	9,000	18,000	18,000	18,000	
Tyre Capacity - Front	7,500	7,500	7,500	7,500	7,500	7,500	7,500	7,500	
Tyre Capacity - Rear	13,000	26,000	26,000	13,000	13,000	26,000	26,000	26,000	
Approx. Body & Payload	10,350	17,500	19,900	28,440	34,450	17,500	17,500	17,500	

NOTE : ( 1 ) = Telma 2 000 Nm retarder

NOTE : ( 2 ) = ISUZU 650 Nm retarder

NOTE : ( 3 ) = Engine driven PTO std on Mixer

\* Introduction 2012 - Date to be advised.